

LeakAlertor® 6000 User's Guide

Installing Your LeakAlertor – This is SO easy!

- 1) **Remove** tank lid.
- 2) **Place** the LeakAlertor over the edge of the tank.

(WARNING: BE CAREFUL NOT TO NICK, DAMAGE, OR SCRAPER THE RED SENSOR WIRE AGAINST THE INSIDE OF THE TANK WHEN INSTALLING OR REMOVING THE UNIT. DAMAGING THIS SENSOR MAY CAUSE THE UNIT TO STOP WORKING PROPERLY.)

- 3) **Replace** tank lid.

- 4) Pull battery tab.

(Gently press the unit against the tank while pulling the tab straight down to remove.)

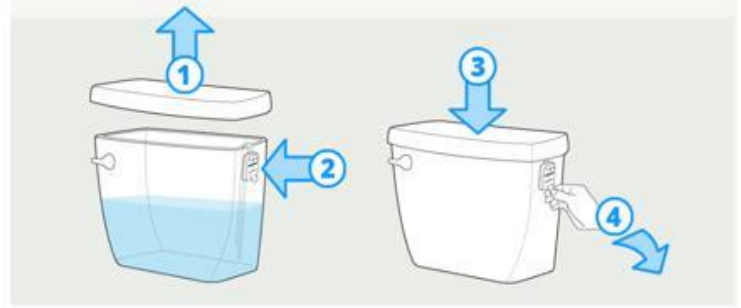

That's It!! You're Done!

I Just Pulled the Battery Tab...Now What Happens?

- When the battery tab was pulled, you probably noticed that the LEDs (the colored lights) flashed and the unit beeped – the LeakAlertor now needs some time to get ready to work on your toilet.
- For the next hour, you will see the **GREEN** LED flashing – this is normal. Feel free to use your toilet during the time – you won't upset the LeakAlertor.
- When the **RED**, **YELLOW**, and **GREEN** LEDs begin to flash together, go ahead and flush the toilet. Don't worry if you can't get to flushing the toilet right away – the LeakAlertor will patiently wait for you.
- The LeakAlertor is now working and will let you know if there is a problem.

How do I know if I have a problem with my toilet?

Every time you flush the toilet; watch and listen to the LeakAlertor!

What to expect when the toilet is flushed*:			
ALERTS	FLASHES/BEEPS	DIAGNOSIS	ACTION REQUIRED
	Continuous Flashes	No problem!	No action required!
	Flashes (after all other alerts)	Battery is low and needs to be replaced	Replace with a CR2032 battery
	2 Flashes + 2 Beeps	Toilet has a leak	Repair necessary. Replacing flapper is recommended
	1 long Beep + 2 short Beeps With Flashes	Faulty fill valve	Replace fill valve (Fluidmaster 400 fill valve is recommended)
	Continuous Flashes + Beeps	Flapper is stuck open or toilet is about to overflow	Shut off water to toilet immediately!! (Alerts won't stop until the problem is corrected or the reset button is pressed).

*See the LA 6000 Support Page on the website for more detailed information.



LeakAlertor® 6000 User's Guide

Using the RESET button

Use the RESET function to:

- Temporarily silence the alerts
 - Make a repair to the toilet
 - Temporarily remove or store the unit
- The RESET button is recessed inside the enclosure as shown in the figure below.
- Use a toothpick or pencil to press the button.

To reset the LeakAlertor:

- 1) **THE LEAKALERTOR MUST BE INSTALLED ON THE TOILET, NOT HELD IN YOUR HAND.**
- 2) **Press and Hold** the *RESET* button. When the **RED** LED illuminates, immediately release the *RESET* button.
- 3) All three LEDs will flash once and the unit will beep once.
- 4) The **GREEN** LED will then flash for about a minute, after which all three LEDs will begin to flash at the same time.
- 5) Once all three LEDs are flashing at the same time **Flush** the toilet to complete the reset.

You're all done, the unit has been reset!!

Testing the LeakAlertor - Easy as 1-2-3

Use the TEST function to *confirm the unit is working as intended.*

- While testing the unit, we recommend removing the toilet tank lid to observe the water height in the tank while the LEDs flash.
- *Wait* at least two to three minutes after you last flushed the toilet to begin a test of the unit.
- The unit will automatically exit the test mode after about three minutes



To test the LeakAlertor:

- 1) **Press and Continue to Hold** the *RESET* button. The **RED** LED will illuminate, and then the **YELLOW** LED will illuminate.
- 2) **Release** the *RESET* button when the **YELLOW** LED illuminates.
- 3) **Flush** the toilet and **watch** the LEDs during the entire flush cycle*:
 - **RED** LED – The water level in the tank is *falling*
 - **GREEN** LED – The water level in the tank is *rising*

* During the flush cycle and/or when the water has reached its lowest level in the tank during the flush, the water turbulence *may* cause the unit to appear as though the LEDs are flashing randomly. The unit is detecting the rising/falling water height of the turbulence and alerting accordingly. Once the water height begins to steadily rise, the unit will continue to flash the **GREEN** LED until the water height stabilizes at the end of the flush.